

Abacus Self-Serve Kiosk

# Pairing and Transaction User Guide

Updated on, by: 04/02/2025, HMS

Reviewed on, by: 05/02/2025, TB

mx51



# Table of Contents

- System Requirements
- Pairing the Point-of-Sale (POS) to the EFTPOS Terminal
- Perform a test Purchase Transaction

# System Requirements

| Systems                     | Requirements  |
|-----------------------------|---|
| Connectivity                | Both the Point-of-sale (POS) system and EFTPOS Terminal need to be connected to the <a href="#">same Local Area Network</a> |
| <a href="#">POS Version</a> | 1.3.4.25869 and above   |
| POS Operating System        | <a href="#">Windows 10 and above</a>  |
| Integration Type            | <a href="#">SPI</a>   |

# Pairing the POS to the EFTPOS Terminal - *Installation Prerequisites* (1 of 3)

## Steps

1. Abacus Kiosk also requires the Abacus iOS App to be installed on site, and running at all times in order for transactions to be sent from the Kiosk to the EFTPOS terminal.
2. A minimum of 2 EFTPOS terminals are required for each merchant site - one to pair with the Kiosk and one to pair with iOS App.
3. In order for the Kiosk to communicate with the iOS App the IP Address of each Kiosk machine has to be configured. This is done through the Communication tab within the iOS App.
4. Master IP can be found here in the iOS app.

## Example Screens

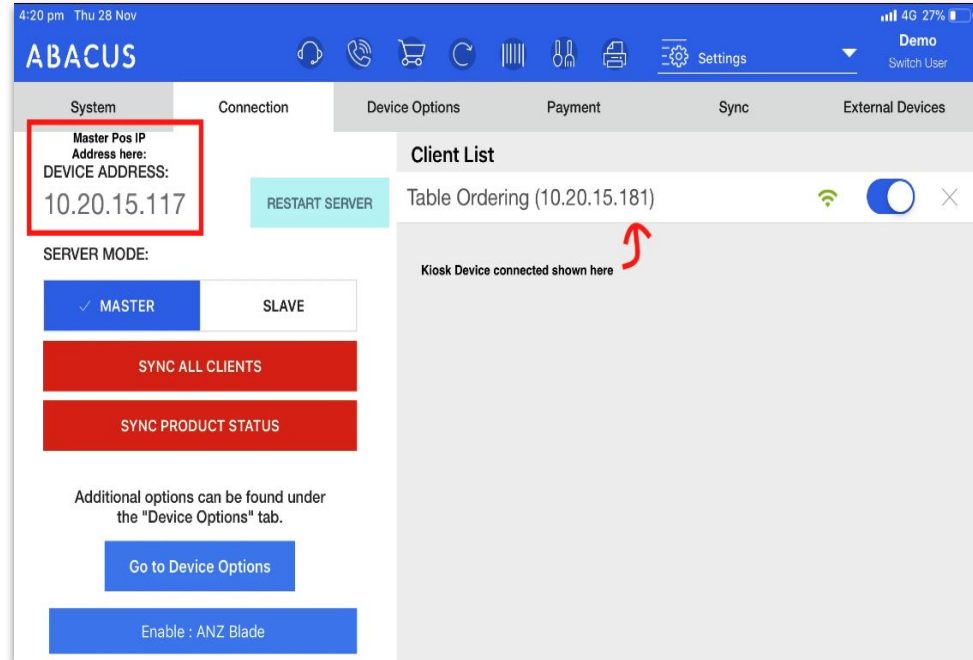

# Pairing the POS to the EFTPOS Terminal - *Installation Prerequisites* (2 of 3)

## Steps

5. On each Kiosk Machine, a Master IP from the iPad needs to be input here

## Example Screens

The screenshot displays the 'Connection' tab of the EFTPOS Terminal configuration interface. The interface is divided into several sections: Menu, POS, Printer, and Scanner. In the Menu section, the 'Server' dropdown is set to 'Dev' (highlighted with a red circle), with 'Live' as an alternative option. Buttons for 'Sync Now' and 'Clear Image Cache' are present. The POS section contains the 'Master POS IP Address' field (set to '10.20.15.112' and highlighted with a red box), the 'Master POS Port' field (set to '8080'), and a 'POS Connection Test' button (also highlighted with a red box). The Printer section shows a 'Printers List' dropdown set to 'TM-T88VII' and a 'Test With Paper' toggle. The Scanner section shows a 'Scanners List' dropdown set to 'Choose Scanner...' and a 'Test Scanner' button. At the bottom, there are 'Close' and 'Submit' buttons. The footer indicates 'all files' with an upward arrow icon.

# Pairing the POS to the EFTPOS Terminal - *Installation Prerequisites* (3 of 3)

## Steps

### Note:

1. Refunds are not supported by the Kiosk itself for security reasons, however transactions made on the Kiosk can be refunded via the iOS App
2. If there's a network disconnection in the middle of a transaction a "Contact staff for assistance" message will be displayed.
3. It is possible to have multiple Kiosks connected to one Master iPad transact at the same time without worries of locking up the other Kiosks.  
This was tested in exploratory testing with 2 Kiosk PCs

# Pairing the POS to the EFTPOS Terminal - (1 of 4)

## Steps

1. Click in the [top right corner](#)
2. Enter the [manager password](#) when prompted
3. Click on the [Payments](#) tab

## Example Screens

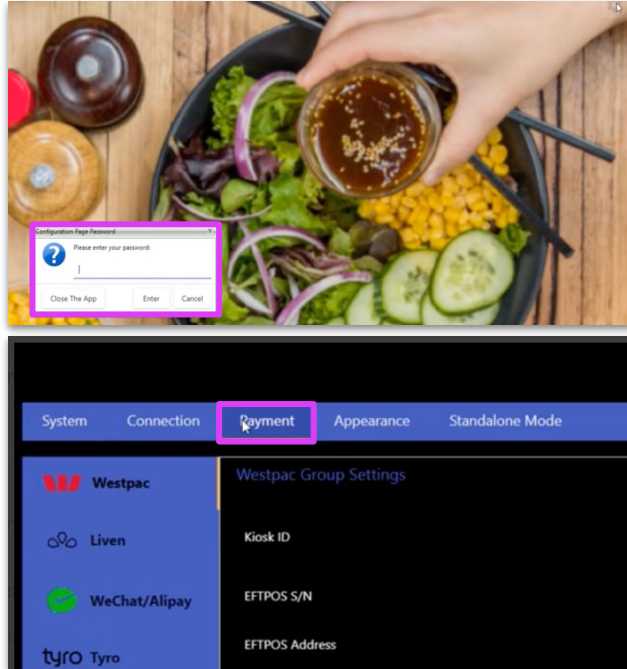

# Pairing the POS to the EFTPOS Terminal - (2 of 4)

## Steps

4. On the **EFTPOS terminal**, Select **Menu**  
*Note: If there is no existing pairing, the "Manage POS pairing" button will show*
5. Select **Manage POS pairing**
6. Select **+**

## Example Screens

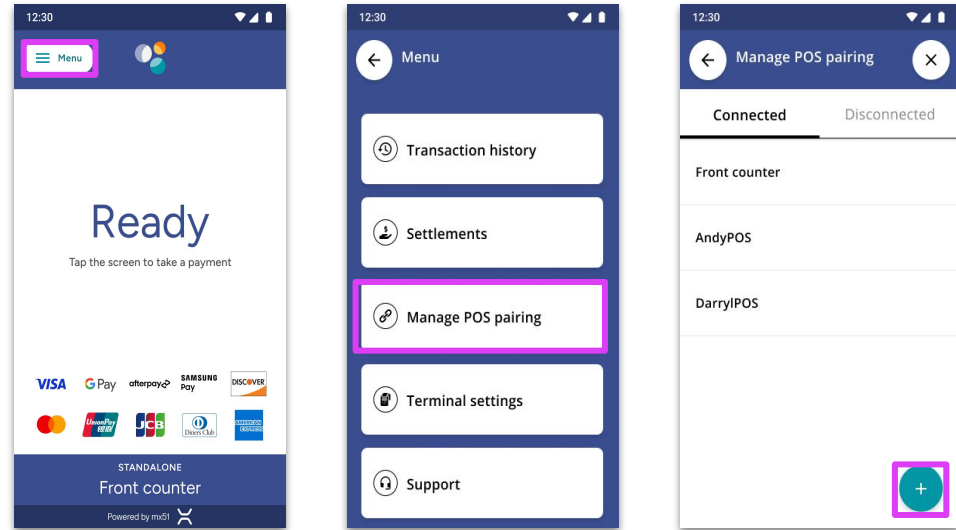

EFTPOS Terminal screens



## Pairing the POS to the EFTPOS Terminal - (3 of 4)

### Steps

7. Enter the [Kiosk ID](#) and [EFTPOS S/N](#)
8. Check the [Automatic](#) checkbox and click on [Save](#)
9. Click on [Pair](#)

### Example Screens

The screenshot shows the 'Westpac Group Settings' interface. A pink rectangular box highlights the top section containing the following fields:

- Kiosk ID:** A text input field containing 'Kiosk22'.
- EFTPOS S/N:** A text input field containing '400-167-188'.
- EFTPOS Address:** A section containing a toggle switch labeled 'Automatic' (which is turned on) and a text input field containing '192.168.1.18'.

Below this highlighted section, there is a 'Test Mode' toggle switch (currently off). To the right of the 'Test Mode' section is a pink rectangular box around the 'Save' button.

At the bottom of the screen, the 'Status' is displayed as 'Unpaired'. Below this, there are two buttons: a pink rectangular box around the 'Pair' button, and a 'Settlement' button to its right.

# Pairing the POS to the EFTPOS Terminal - (4 of 4)

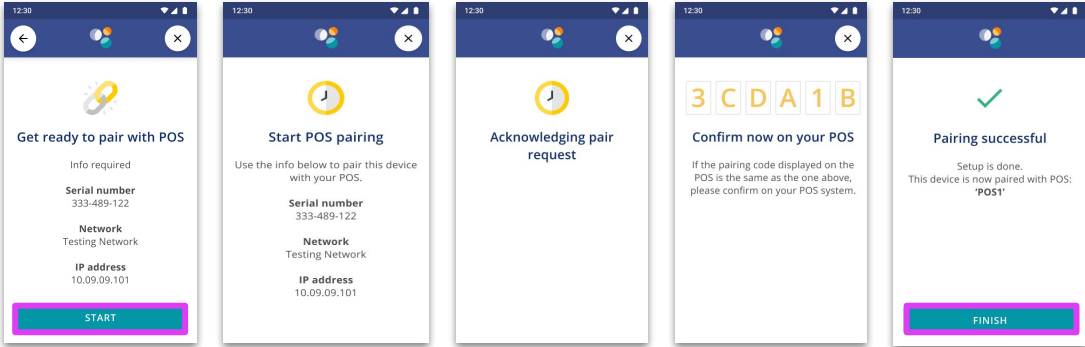
| Steps   | Example Screens   |
|---|---|
| <p>10. On the <b>EFTPOS Terminal</b>:</p> <ul style="list-style-type: none"><li>○ Select <b>START</b></li><li>○ Ensure the code displayed matches what is displayed on POS and select <b>YES</b></li><li>○ Select <b>FINISH</b></li></ul> |  <p>The five screenshots show the following steps:</p> <ol style="list-style-type: none"><li><b>Get ready to pair with POS</b>: Displays required information: Serial number (333-489-122), Network (Testing Network), and IP address (10.09.09.101). A green <b>START</b> button is at the bottom.</li><li><b>Start POS pairing</b>: Instructs the user to use the provided info to pair the device. Displays the same serial number, network, and IP address. A green clock icon is at the top.</li><li><b>Acknowledging pair request</b>: A screen with a green clock icon and the text 'Acknowledging pair request'.</li><li><b>Confirm now on your POS</b>: Shows a 6-digit pairing code (3 C D A 1 B) in colored boxes. Below, it says 'Confirm now on your POS' and provides instructions to verify the code on the POS system.</li><li><b>Pairing successful</b>: Shows a green checkmark and the text 'Pairing successful'. Below, it says 'Setup is done. This device is now paired with POS: 'POS1''. A green <b>FINISH</b> button is at the bottom.</li></ol> |

*EFTPOS Terminal screens*

# Perform a Test Purchase Transaction - (1 of 2)

## Steps

To perform a test Purchase Transaction to ensure that the integrated solution is working;

1. Select the **Product**
2. Select **Checkout**
3. Select **Take Away**
4. Select **CARD**

## Example Screens

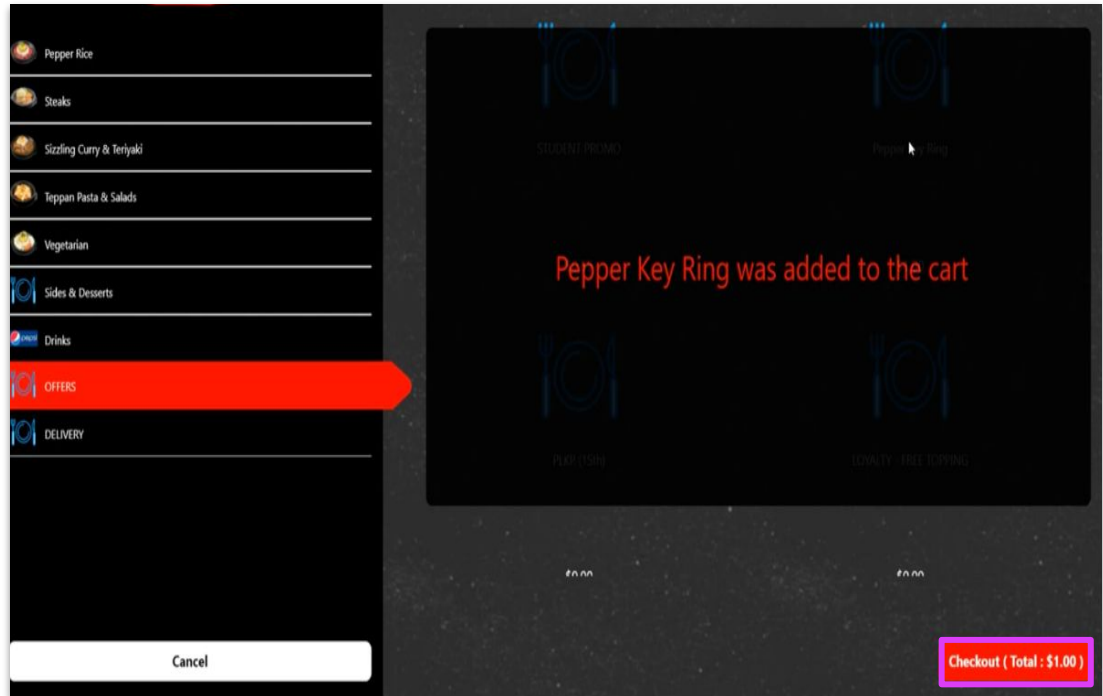

## Perform a Test Purchase Transaction - (2 of 2)

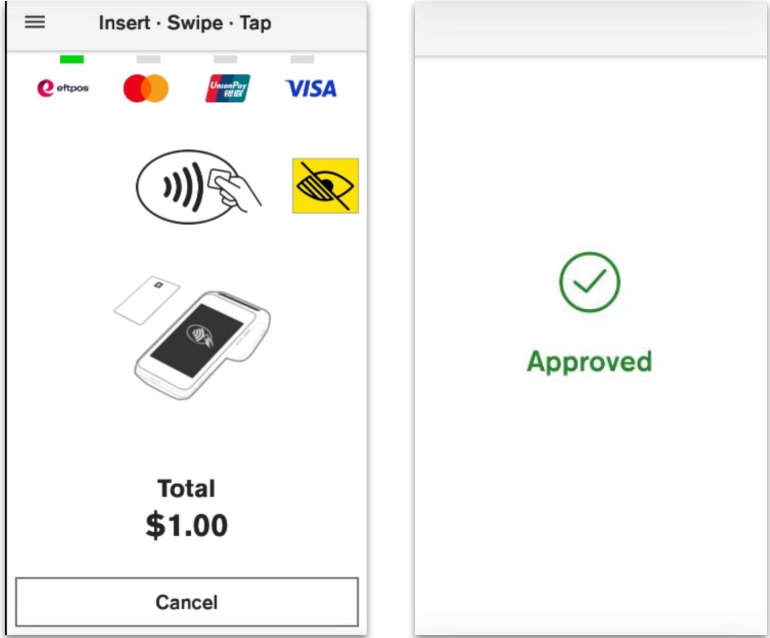
| Steps   | Example Screens  |
|---|--|
| <p>5. Complete Payment on EFTPOS terminal</p> |  <p><i>EFTPOS Terminal screens</i></p> |